

## C Series



## CB Series



## CBR Series



### Application

The clamps are designed for quick and reliable mounting and connection of various round ventilation system components. The clamps facilitate installation process and fan removal for servicing and maintenance.

### Design

- C series clamps are made of stainless steel band and CZ series clamps are made of galvanized steel band. The clamps are tightened with a screw.

- CB series clamps are the stainless steel quick-release clamps equipped with a stainless steel swing screw. The clamps are tightened with a screw.

- The CBR 3000 model is a band clamp in a plastic casing (roll 30 m x 9 mm x 0.8 mm). Additional locking devices are necessary (SU 50). Use a clamp band of respective length and a locking device to get the necessary clamp diameter. The clamps are tightened with a screw. You will only need snips to create the desired diameter clamp, as the plastic casing has a special design and necessary marking.

Use:

1. Bend the edge of the band;
2. Fix the bent end inside the band holder;
3. Turn the band holder up to the required diameter marking on the casing;
4. Cut the band according to the marking on the casing;
5. Fix the locking device on the band clamp.

### Overall dimensions

Model	Dimensions [mm]	
	ØD	H
C 100	90-110	9
C 125	110-130	9
C 150	140-160	9
C 160	150-170	9
C 200	190-210	9
C 250	240-260	9
C 315	300-330	9

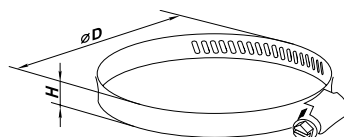
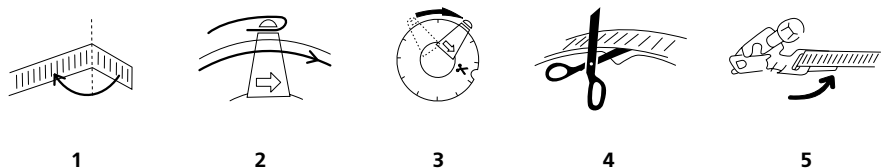

Locking device SU 50 for CBR 3000

### Overall dimensions

Model	Dimensions [mm]	
	ØD	H
CB 60-110	60-110	9
CB 60-135	60-135	9
CB 60-165	60-165	9



Easy locking mechanism for the CB and CBR clamps